

LUG BUTTERFLY VALVE

凸耳式软密封蝶阀

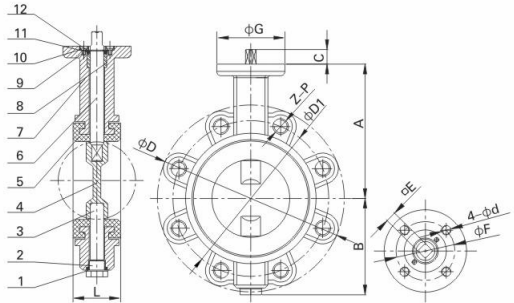

MV-92D/92F

- 法兰标准: DIN EN1092-1 PN16 (MV-92D)
ASME B16.5 Class150 (MV-92F)
- 结构长度: EN558 Series 20
- 工作温度: $-10^{\circ}\text{C}\sim+150^{\circ}\text{C}$
- 驱动盘标准: ISO5211
- 材 料: CF8M, CF8, CF3M, WCB

- Flanged ends: DIN EN1092-1 PN16 (MV-92D)
ASME B16.5 Class 150 (MV-92F)
- Face to Face: EN558 Series 20
- Working temperature: $-10^{\circ}\text{C}\sim+150^{\circ}\text{C}$
- Mounting pad: ISO5211
- Material: CF8M, CF8, CF3M, WCB

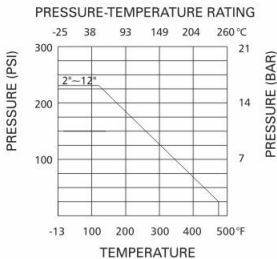

MATERIAL LIST

ITEM	PART	MATERIAL	QTY.
1	Plug	SS304	1
2	Gasket	PTFE	1
3	Lower Stem	SS316	1
4	Disc	CF8M	1
5	Seat	VITON/EPDM/PTFE	1
6	Stem	SS316	1
7	Body	CF8M	1
8	Braring	PTFE	1
9	Screw	SS304	2
10	Tablet Press	SS304	1
11	Stem Ring	SS304	2
12	Retainer	SS316	1

DIMENSION LIST

	SIZE	A	B	C	ϕD	E	ϕF	ϕG	$\phi D1$	ϕd	Z-M	L
MV-92D	DN50	126	78	13.5	165	9	50	70	125	9	4-M16	43
MV-92F	DN50	126	78	13.5	150	9	50	70	120.5	9	4-M16	43
MV-92D	DN65	134	84	13.5	185	9	50	70	145	9	4-M16	46
MV-92F	DN65	134	84	13.5	180	9	50	70	139.5	9	4-M16	46
MV-92D	DN80	138	92	13.5	200	9	50	70	160	9	8-M16	46
MV-92F	DN80	138	92	13.5	190	9	50	70	152.5	9	8-M16	46
MV-92D	DN100	167	114	13.5	220	11	70	90	180	11	8-M16	52
MV-92F	DN100	167	114	13.5	230	11	70	90	190.5	11	8-M16	52
MV-92D	DN125	180	129	17.5	250	14	70	90	210	11	8-M16	56
MV-92F	DN125	180	129	17.5	255	14	70	90	216	11	8-M16	56
MV-92D	DN150	203	144	17.5	285	14	70	90	240	11	8-M20	56
MV-92F	DN150	203	144	17.5	280	14	70	90	241.5	11	8-M20	56
MV-92D	DN200	228	179	24.5	340	17	102	125	295	13	12-M20	60
MV-92F	DN200	228	179	24.5	345	17	102	125	298.5	13	12-M20	60
MV-92D	DN250	266	216	25	405	22	102	125	355	13	12-M24	68
MV-92F	DN250	266	216	25	405	22	102	125	362	13	12-M24	68
MV-92D	DN300	291	247	25	460	22	102	125	410	13	12-M24	78
MV-92F	DN300	291	247	25	485	22	102	125	431.5	13	12-M24	78